

PERMIT

CITY OF NAPOLEON - BUILDING DEPARTMENT
 255 West Riverview Avenue, Napoleon, Ohio 43545 - 419-592-4010

Permit No. 01396 Issued 6-25-87
date

Job Location 130 Wayne Park Drive
address

Lot 3 NE 1/4 of the NW 1/4 Section 27
sub-div or legal discript

Issued By Eldon Huber
building official

Owner Wilburn W Hart 599-2591
name tel.

Address 130 Wayne Park Drive

Agent Blue Water Pools 893-4854
builder-eng.-etc. tel.

Address 1212 Conant St. Maumee, OH

Description of Use Residence

Residential 1
no. dwelling units

Commercial _____ Industrial _____
Inground pool

New Add'n. _____ Alter _____ Remodel _____

Mixed Occupancy _____

Change of Occupancy _____

Estimated Cost \$ 5,500.00

| FEE | BASE | PLUS | TOTAL |
|--|-------------------|------------------|--------------|
| <input checked="" type="checkbox"/> BUILDING | <u>6.00</u> | <u>27.50</u> | <u>33.50</u> |
| <input checked="" type="checkbox"/> ELECTRICAL | <u>10.00</u> | <u>2.00</u> | <u>12.00</u> |
| <input type="checkbox"/> PLUMBING | | | |
| <input type="checkbox"/> MECHANICAL | | | |
| <input type="checkbox"/> DEMOLITION | | | |
| <input type="checkbox"/> ZONING | | | |
| <input type="checkbox"/> SIGN | | | |
| WATER TAP | | | |
| SEWER TAP | | | |
| TEMP. ELECT. | | | |
| ADDITIONAL PLAN REVIEW | Struct. _____ hrs | Elect. _____ hrs | |
| TOTAL FEES..... | | | <u>45.50</u> |
| ELEC. PERMIT, PAID | | | <u>12.00</u> |
| LESS MIN. FEES PAID | | | <u>12.00</u> |
| BALANCE DUE..... | | | <u>33.50</u> |

ZONING INFORMATION

| district | lot dimensions | | area | front yd | side yds | rear yd |
|------------|----------------|---------------|------------|--------------------------|--------------|------------|
| <u>5</u> | | | | <u>70'</u> | <u>L-12'</u> | <u>50'</u> |
| max hgt | no pkg spaces | no ldg spaces | max cover | petition or appeal req'd | | date appr |
| <u>35'</u> | <u>2-min</u> | | <u>30%</u> | | | |

WORK INFORMATION: Inground pool

Size: Length 30' Width 15' Stories _____ Ground Floor Area 4,505 S.F.

Height 0' Building Volume (for demo. permit) _____ cu. ft.

Electrical: _____
brief description

Plumbing: N.A.
brief description

Mechanical: N.A.
brief description

Sign: N.A. Dimensions _____ Sign Area _____
type

Additional Information: See plan correction sheet.

Date 7-7-87 Applicant Signature Robert J Han
owner-agent

PAID
 JUL 7 1987
 CITY OF NAPOLEON

INSPECTION RECORD

| | UNDERGROUND | | | ROUGH-IN | | | | | | FINAL | | |
|-------------------|---------------------------------------|------|----|--|------|----|---|------|----|---|------|----|
| | Type | Date | By | Type | Date | By | Type | Date | By | Type | Date | By |
| PLUMBING | Building Drains | | | Drainage, Waste & Vent Piping | | | Indirect Waste | | | Drainage, Waste & Vent Piping | | |
| | Water Piping | | | | | X | | | | Backflow Prevention | | |
| | Building Sewer | | | Water Piping | | X | Condensate Lines | | | Water Heater | | |
| | | | | | | | | | | | | |
| | Sewer Connection | | | | | | | | | FINAL APPROVAL | | |
| MECHANICAL | Refrigerant Piping | | | Refrigerant Piping | | | Chimney(s) | | | Grease Exhaust System | | |
| | | | | Duct Furnace(s) | | | Fire Dampers | | | Air Cond. Unit(s) | | |
| | Ducts/Plenums | | | Ducts/Plenums | | | <input type="checkbox"/> Radiant Htr(s) <input type="checkbox"/> Unit Htr(s) | | | Refrigeration Equipment | | |
| | | | | Duct Insulation | | | Pool Heater | | | Furnace(s) | | |
| | | | | Combustion Products Vents | | | Ventilation <input type="checkbox"/> Supply <input type="checkbox"/> Exhst. | | | FINAL APPROVAL | | |
| ELECTRICAL | Conduits & or Cable | | | Conduits/Cable | | | <input type="checkbox"/> Range <input type="checkbox"/> Dryer | | | Temp Service Temp Lighting | | |
| | Grounding & or Bonding | | FH | Rough Wiring | | | <input type="checkbox"/> Generator(s) <input type="checkbox"/> Motors | | | Fixtures Lampholders | | |
| | Floor Ducts Raceways | | | Service Panel Switchboard | | | <input type="checkbox"/> Water Htr <input type="checkbox"/> Welder | | | Signs | | |
| | Service Conduit | | | Busways Ducts | | | <input type="checkbox"/> Heaters <input type="checkbox"/> Heat Cable | | | Electric Mtr. Clearance | | |
| | Temporary Power Pole | | | Subpanels | | | <input type="checkbox"/> Duct Htr(s) <input type="checkbox"/> Furnace(s) | | | FINAL APPROVAL | | |
| BUILDING | Location, Set-backs, Esmt(s) | | FH | Exterior Wall Construction | | | Roof Covering Roof Drainage | | | Smoke Detector | | |
| | Excavation | | | | | | Exterior Lath | | | Demolition (sewer cap) | | |
| | Footings & Reinforcing | | | | | | <input type="checkbox"/> Interior Lath <input type="checkbox"/> Wallboard | | | | | |
| | Floor Slab | | | Interior Wall Construction | | | Fire Wall(s) | | | Building or Structure | | |
| | Foundation Walls | | | Columns & Supports | | | Fireplace Chimney | | | | | |
| | Sub-soil Drain | | | Crawl Space <input type="checkbox"/> Vent <input type="checkbox"/> Access | | | Attic <input type="checkbox"/> Vent <input type="checkbox"/> Access | | | | | |
| | Piles | | | Floor System(s) | | | | | | FINAL APPROVAL BLDG. DEPT. * 8/87 FH | | |
| | | | | Roof System | | | Special Insp Reports Rec'd | | | Certificate of Occupancy Issued | | |
| ADDITIONAL | INSPECTIONS, CORRECTIONS, ETC. | | | | | | INSPECTIONS, CORRECTIONS, ETC. | | | | | |
| | NEED SELF CLOSING | | | | | | | | | | | |
| | DEVICR FOR GATE | | | | | | 8/11 FH | | | | | |

CITY OF NAPOLEON
 55 West Riverview Ave.
 Napoleon, Ohio 43545
 19/592-4010

ADDENDUM TO Permit No. 01396 - (1)
 Owner WILL DURD HAPT
 Contractor BLUE WATER POOLS
 Location 130 WAYNE PARK DR.

Note the items checked below and incorporate them into your plans as indicated: PERMIT NOT ISSUED, CORRECT PLANS AND RE-SUBMIT. PERMIT ISSUED, INCORPORATE ITEMS DURING CONSTRUCTION.

| GENERAL | | Show size of members supporting porch roof. | |
|--|--|--|--|
| Provide approved smoke detector(s) as req'd. | | Provide double top plate for all bearing partitions and exterior walls. | |
| Provide 1/2" gypsum wallboard between dwelling and garage, on garage side. | | Provide design data for prefab wood truss. | |
| Provide min. 1 3/8" solid wood door from garage to dwelling. (or equal) | | Ceiling joists undersized in _____. | |
| Submit fully dimensioned plot plan. | | Roof rafters undersized in _____. | |
| Provide min. of 1-3'0" x 6'8" exit door. | | PLUMBING AND MECHANICAL | |
| Provide min. 22" x 30" attic access opening. | | Terminate all exhaust systems to outside air. | |
| Provide min. 18" x 24" crawl space access opening. | | Insulate ducts in unheated areas. | |
| Provide approved sheathing or flashing behind masonry veneer. | | Provide backflow prevention device on all hose bibs. | |
| Provide min. 15# underlayment on roof. | | Terminate pressure and temperature relief valve drain in an approved manner. | |
| Provide adequate fireplace hearth. | | Provide dishwasher drain with approved air gap device. | |
| Install factory built fireplaces/stoves according to manufacturers instructions. | | METAL VENEERS | |
| Terminate chimney 2' above roof or 2' above highest point of building within 10' of chimney. | | Contact City Utilities Dept. to remove conductors and/or meter. | |
| LIGHT AND VENTILATION | | Provide approved system of grounding and bonding. | |
| Provide mechanical exhaust or window in bathroom | | ELECTRICAL | |
| Provide min. _____ Sq. In. net free area attic ventilation. | | Show location of service entrance panel and service equipment panel. | |
| Provide min. _____ Sq. In. net free area crawl space ventilation. | | G. F. C. I. req'd. on temporary electric. | |
| FOUNDATION | | Outdoor, bathroom and garage receptacles shall be protected by G. F. C. I. | |
| Min. depth of foundation below finished grade is 32". | | Maximum number of receptacles permitted on a G. F. C. I. circuit shall be 10 for 20 A. circuits and 7 for 15A. circuits. | |
| Min. size of footer _____" x _____". | | Refrigerators, microwaves, washers, disposal, furnace and air conditioners shall be on separate circuits. | |
| Provide anchor bolts 1/2" @ 6' o.c. 1' from each corner. Embedded 7" in concrete and 15" in masonry. | | INSPECTIONS | |
| Show size of basement columns. | | The following indicated inspections are required. The owner or his agent shall contact the City Building Dept. at least 24 hrs prior to the time the inspection is to be made. | |
| FRAMING | | Footers and Setbacks. | Building sewer. |
| Show size of wood girder in _____. | | Foundation. | HVAC rough-in. |
| Provide design data for structural member in _____. | | Plumbing rough-in. | <input checked="" type="checkbox"/> Final Building |
| Floor joists undersized in _____. | | Plumbing final. | other, |
| Provide double joists under parallel bearing partitions. | | Electrical service. | <input checked="" type="checkbox"/> <u>GROUNDING</u> |
| Provide 1" x 4" let in corner bracing, approved sheathing, or equal. | | Electrical rough-in. | |
| Show size of headers for openings over 4' wide _____. | | Electrical final | |

Additional Corrections. PROVIDE A MIN. 4'-0" HIGH FENCE WITH SELF CLOSING GATE AROUND POOL. GROUND ALL METAL PART, PROVIDE G.F.C.I. FOR ALL CIRCUITS. PROVIDE SMOKE DETECTORS AS REQ. IN EXISTING HOUSE.

The approval of plans and specifications does not permit the violation of any section of the Building Code or other City Ordinance. This addendum is attached to Permit No. 01396 and made a part thereof. DATE APPROVED OR DISAPPROVED 6-23-87 Checked by _____ Plan Examiner. CITY OF NAPOLEON

DATE RECHECKED AND APPROVED _____ Checked by _____

FIELD CORRECTION NOTICE

LOCATION 180 WAYDE PARK DRIVE PERMIT NO. 01450
ISSUED TO OBERHAUS POOLS
PERMIT HOLDER AND/OR ALL RESPONSIBLE PARTIES.

NOTICE DELIVERED TO OBERHAUS POOLS 115 W. WASHINGTON
Upon inspection, violations of the _____ Sec. _____ were in evidence.

The following orders are hereby issued for their correction: GROUND ALL METAL
SURFACES WITH GROUND RODS, CABLES AND CONNECTIONS

PLEASE CALL FOR INSPECTION WHEN CORRECTIONS HAVE BEEN COMPLETED. ACCEPTANCE
AND APPROVAL BY AN INSPECTOR OF THIS DEPARTMENT IS REQUIRED AND MUST BE CORRECTED
ON OR BEFORE 5-20-88

DATE 5-12-88

BY ELDON HODER
INSPECTOR

PINK - ORIGINAL COPY WHITE - FIELD COPY YELLOW - FILE COPY

FIELD CORRECTION NOTICE

LOCATION 180 WAYNE PARK DRIVE PERMIT NO. D1250

ISSUED TO ODDENDS POOLS
PERMIT HOLDER AND/OR ALL RESPONSIBLE PARTIES.

NOTICE DELIVERED TO ODDENDS POOLS 115 W. WASHINGTON

Upon inspection, violations of the _____ Sec. _____ were in evidence.

The following orders are hereby issued for their correction: GROUND ALL WITH
SUBFENCE WITH GROUND RODS, CHILLS AND CONNECTIONS

PLEASE CALL FOR INSPECTION WHEN CORRECTIONS HAVE BEEN COMPLETED. ACCEPTANCE AND APPROVAL BY AN INSPECTOR OF THIS DEPARTMENT IS REQUIRED AND MUST BE CORRECTED ON OR BEFORE 5-20-88

DATE 5-12-88

BY ELDON HUIER
INSPECTOR

PINK - ORIGINAL COPY WHITE - FIELD COPY YELLOW - FILE COPY

PERMIT

CITY OF NAPOLEON - BUILDING DEPARTMENT

01396 255 West Riverview Avenue, Napoleon, Ohio 43545 - 419-592-4010

Permit No. [REDACTED] Issued 6-23-87
date

Job Location 130 WAYNE PARK DRIVE
address

Lot NE 1/4 OF T4D NW 1/4 SEC. 27
sub-div or legal discript

Issued By EH
building official

Owner WILBURN W HART 599-2591
name tel.

Address 130 WAYNE PARK DRIVE

Agent BLUE WATER POOLS 893-4819
builder-eng.-etc. tel.

Address 1212 CONANT ST MAUMEE, OH

Description of Use RESIDENCE

Residential 1
no. dwelling units

Commercial _____ Industrial _____

New X Add'n. _____ Alter _____ Remodel _____
IN GROUND - POOL

Mixed Occupancy _____

Change of Occupancy _____

Estimated Cost \$ 5500.00

ZONING INFORMATION

| | | | | | |
|-----------------------|-------------------------------|---------------|-------------------------|--------------------------|-----------------------|
| district <u>5</u> | lot dimensions | area | front yd <u>70'</u> | side yds <u>6-12'</u> | rear yd <u>50'</u> |
| max hgt <u>35'</u> | no pkg spaces <u>2-MIN</u> | no ldg spaces | max cover <u>30%</u> | petition or appeal req'd | date appr |

WORK INFORMATION: IN GROUND POOL

Size: Length 30' Width 15' Stories _____ Ground Floor Area 450 S.F.

Height 0' Building Volume (for demo. permit) _____ cu. ft.

Electrical: _____

Plumbing: N.A. brief description

Mechanical: N.A. brief description

Sign: N.A. Dimensions Sign Area

Additional Information: SEE PLAN CORRECTION SHEET.

~~EXISTING POOL (PROVIDE SMOKE DETECTOR IN EXISTING POOL AS REQ. GROUND HCC MECHANICAL, ELECTRICAL AND PLUMBING)~~

Date _____ Applicant Signature _____ owner-agent

| FEES | BASE | PLUS | TOTAL |
|--|-------------------|------------------|--------------|
| <input checked="" type="checkbox"/> BUILDING | 6.00 | 27.50 | 33.50 |
| <input checked="" type="checkbox"/> ELECTRICAL | 10.00 | 2.00 | 12.00 |
| <input type="checkbox"/> PLUMBING | | | |
| <input type="checkbox"/> MECHANICAL | | | |
| <input type="checkbox"/> DEMOLITION | | | |
| <input type="checkbox"/> ZONING | | | |
| <input type="checkbox"/> SIGN | | | |
| WATER TAP | | | |
| SEWER TAP | | | |
| TEMP. ELECT. | | | |
| ADDITIONAL PLAN REVIEW | Struct. _____ hrs | Elect. _____ hrs | |
| TOTAL FEES..... | | | <u>45.50</u> |
| LESS MIN. FEES PAID _____ | | | |
| BALANCE DUE..... | | | |

WILBURN HART

BLUE WATER POOLS

130 WAYNE PARK

IN GRASSY POOL OVAL

15' X 30' X 3'-5"

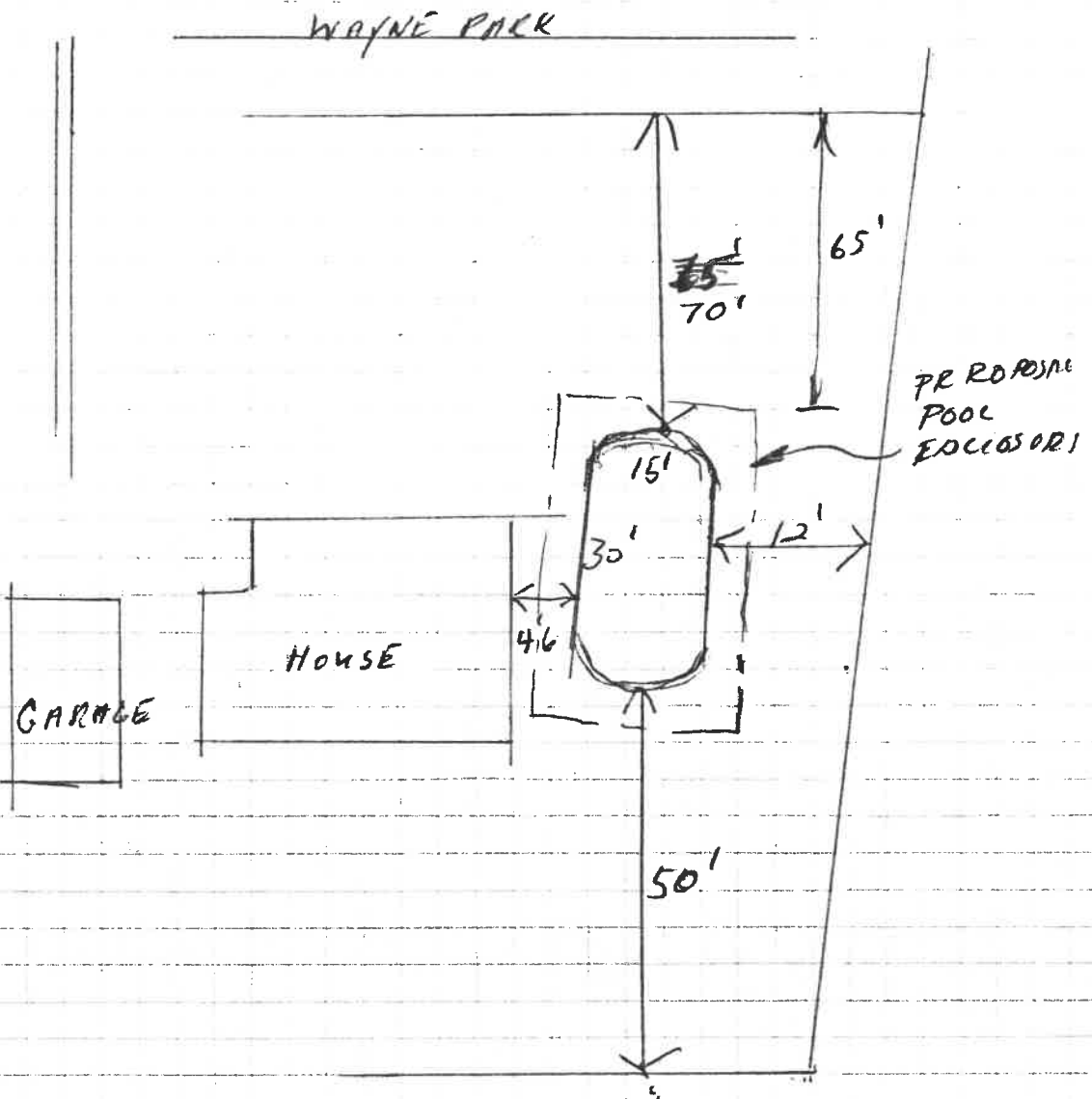

CITY OF NAPOLEON
BUILDING INSPECTION DEPARTMENT
APPLICATION FOR BUILDING PERMIT
(Please print or type)

The undersigned hereby makes application for construction, installation, or alteration work as herein specified, agreeing to do all such work in strict accordance with the City of Napoleon's adopted Building Codes.

599-2591

Location of project 130 WAYNE PARK DR Cost of project 5500⁰⁰

Owner's Name WILBURN W HART Address 130 WAYNE PARK

Contractor BLUE WATER POOLS INC. Telephone No. 993-4854

Address 1212 CONANT ST MAUMEE OH

Lot Information: (Not required for siding job)

Lot No. 130 Subdivision _____

Zoning District _____ Lot Size _____ ft. X _____ ft. Area _____ sq. ft.

Setbacks: Front 65 Right Side 120 Left Side 12 Rear 50'

Work Information:

Residential Commercial _____ Industrial _____

New Construction _____ Addition _____ Remodel _____

Accessory Building _____ Siding _____
(Specific Type)

Brief Description of Work:----- IN GROUND SWIMMING POOL OVAL

Size: Length 30 Width 15 No. of Stories _____

Area: 1st Floor _____ sq. ft. Basement _____ sq. ft.

2nd Floor _____ sq. ft. Accessory Bldg. _____ sq. ft.

3rd Floor _____ sq. ft. Other _____ sq. ft.

Additional Information: _____

APPLICATION FOR PERMIT SHALL BE ACCOMPANIED BY TWO COMPLETE SETS OF PLANS INCLUDING: ELEVATIONS, FLOOR PLANS, CROSS SECTIONS AND PLOT PLAN. IF ADDITION OR REMODELING, SHOW ALL EXISTING STRUCTURES AND THEIR SIZE AND LOCATION. ALL PLANS SHALL BE DRAWN TO SCALE.

Date 6-22-87 Applicant's Signature Robert J. Nau

ROBERT NAU.

PERMIT NO.

PERMIT FEE \$



City of NAPOLEON, OHIO

255 RIVERVIEW AVENUE - (419) 592-4010
NAPOLEON, OHIO 43545-0151

July 17, 1987

Mayor

Robert G. Heft

Members of Council

William Young, President
Lawrence Haase
James Hershberger
Donald Stevens
Donald Morford
Steve White

Wilburn W. Hart
130 Wayne Park Drive
Napoleon, Ohio 43545

Re: Board of Zoning Appeals
Hearing in regards to your
Variance request for your
pool enclosure.

City Manager

Richard A. Hayward

Dear Mr. Hart:

Clerk-Treasurer

Rupert W. Schweinhagen

The Board voted to continue the Hearing to a later date (you will be notified of the new date) and to request the following:

Law Director

Keith P. Muehlfeld

- A. That you and Mrs. Hart be present at the meeting to answer any questions the Board may have.
- B. The Board would like to have some idea of what the enclosure would look like. And has requested that you furnish exterior elevations for their review.

If you have any questions, please feel free to call me or Mr. Richard A. Hayward, the City Manager.

Sincerely,

Eldon Huber
Building Inspector

cc: Richard A. Hayward

EH:skw

PROJECT RECORD FORM

JOB NUMBER _____

| DATE | REMARKS |
|-----------|--|
| 22 AUG 85 | |
| 12:00 AM | |
| / | <p>ABOVE GROUND POOL S-RES</p> <p>RESTRICTIONS-- LOT 3</p> |
| | 10 FOOT SIDE SETBACK |
| | 10 FOOT REAR SETBACK |
| | 75 FOOT FRONT SETBACK |
| | GFCI PROTECTED |
| | EITHER AT RECEPTACLE OR AT DISCONNECT |
| | MUST BE PROTECTED BY 3' FENCE OR OTHER |
| | MEANS |
| | |
| | |
| | |
| | |
| | <i>Paul E. Buehner</i> |
| | West side yard can not meet |
| | set back requirement of 10' |
| | because of house + septic tank |
| | Owners cancelled |
| | |
| | |
| | |
| | |
| | RGS |
| | |
| | 8/26/85 |
| | |
| | |
| | |
| | |
| | |
| | |
| | |

MEMORANDUM

TO: Members of the Board of Zoning Appeals
FROM: Richard A. Hayward, City Manager *RAH*
SUBJECT: Request for Variance - Wilburn Hart
DATE: July 8, 1987 *BZA 87-18*

RECOMMENDATION

It is recommended that the Board of Zoning Appeals approve a Variance for Wilburn and Anna Hart to allow the construction of an enclosed swimming pool in the side yard setback at their house at 130 Wayne Park Drive.

BACKGROUND

A petition has been received from Wilburn W. and Anna F. Hart, 130 Wayne Park Drive, Napoleon, Ohio requesting a Variance to allow the construction of an enclosed swimming pool in the side yard setback at their property. The Hart's would like to enclose a pool they are building and in order to do so must build 3 feet into the 10 foot side yard setback.

Staff has no problem with the request. Without the Variance the enclosure could not be put over the pool in its proposed location. In addition, it would be difficult to locate the pool in the back yard.

The request meets the Standards for Variation in the following manner:

- 1) The enclosure could not be put over the pool without the Variance, nor could it be placed in the back yard without a Variance which creates an exceptional situation.
- 2) The Variance is needed to allow construction on the property which is a right enjoyed by others in the district.
- 3) Granting the Variance will not be materially detrimental to the public welfare.
- 4) Granting the Variance will not alter the land use characteristics of the district.

RAH:skw

